

AC Triac Series

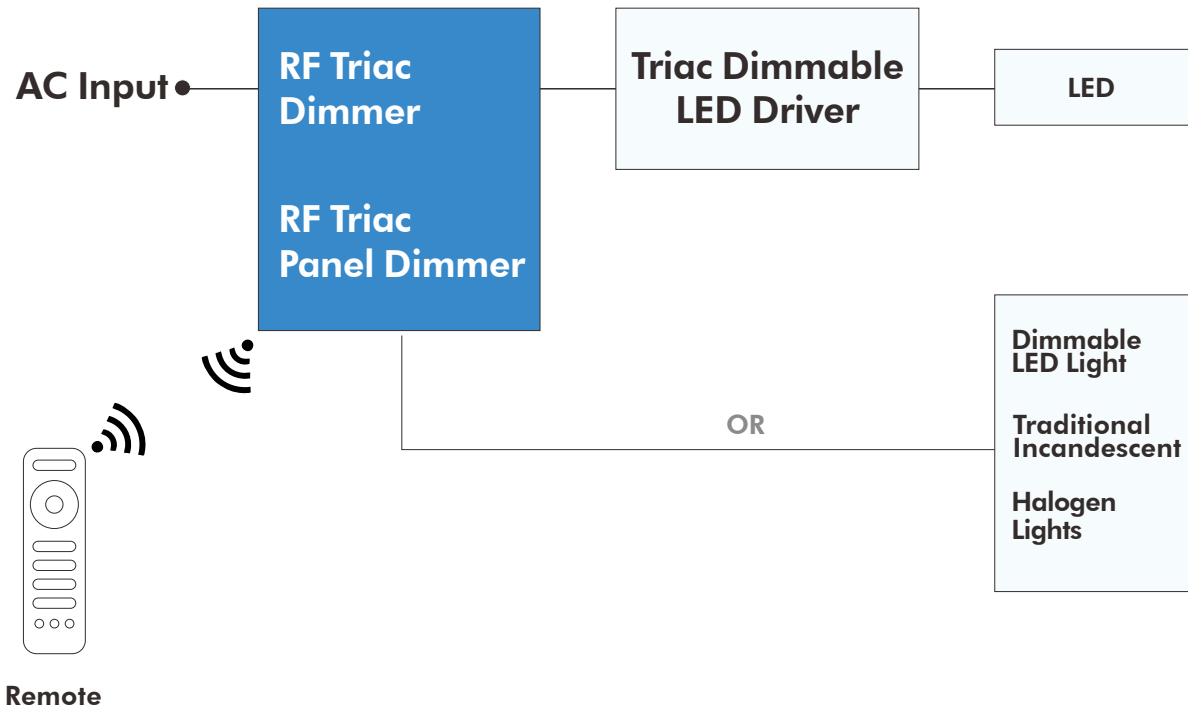

AC Triac Series

Skydance offers a complete AC Triac control system that contains Triac dimmer/ switch, Triac dimmable LED driver, and DMX512 Triac Converter.

The Triac dimmer with AC input and AC output to dim and switch single color dimmable LED lamps, traditional incandescent and halogen lights. Working with a WiFi-Relay converter, the Triac dimmer can be WiFi controlled via APP installed on IOS or Android devices. It is also compatible with a variety of single color RF remotes.

Triac dimmable LED driver supports to dim the LEDs' brightness from 0 to 100% without any flicker. They are all compatible with major control systems of Lutron, Dynalite, Clipsal, Osram, Philips, ABB, Schneider, Simens, Berker, legrand etc.

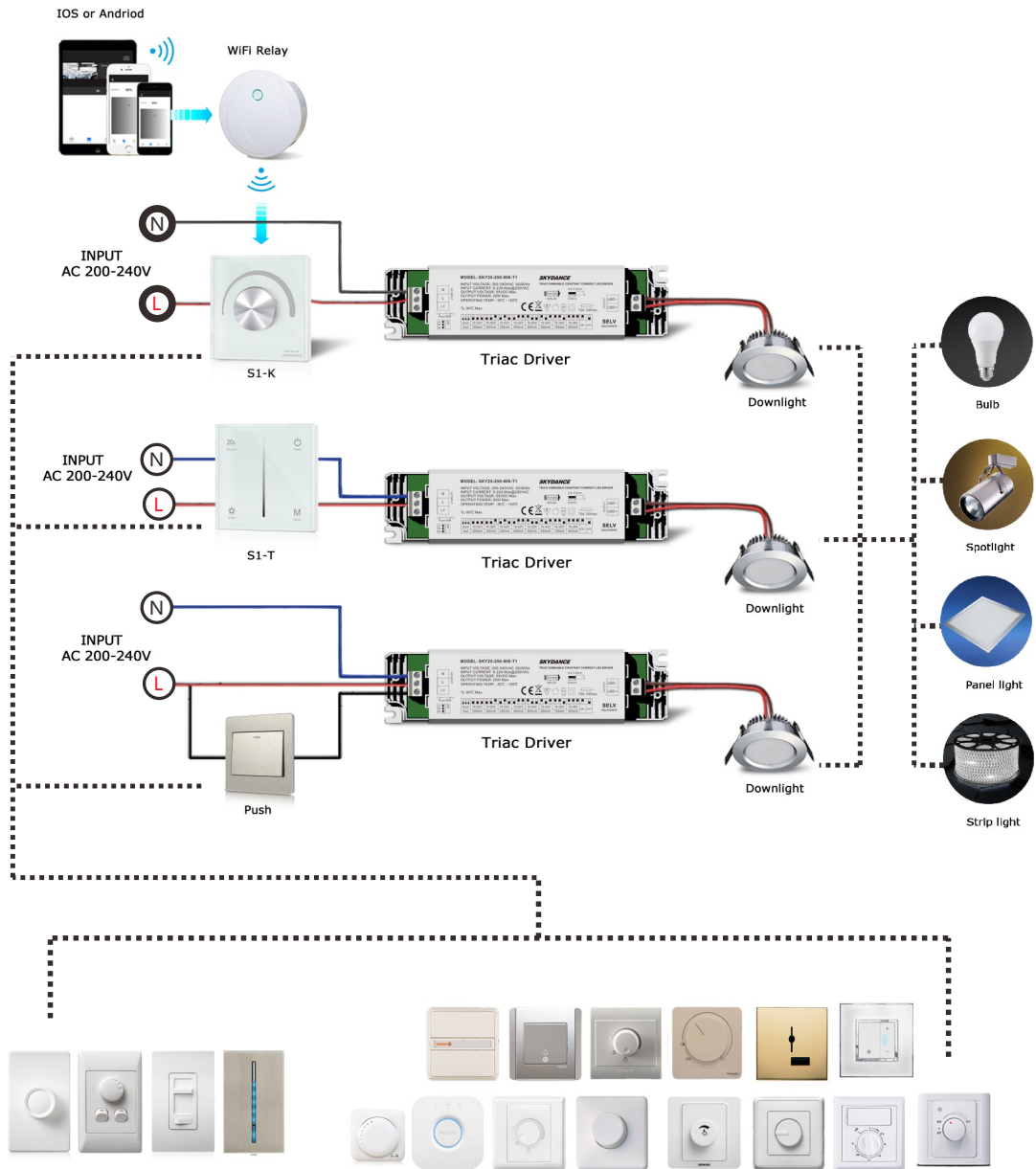

AC Triac Dimmer

AC phase-cut Dimmer(RF + Push Dim)



- Leading edge or trailing edge dimming.
- To dim and switch dimmable LED lamps, traditional incandescent and halogen lights.
- Dimming range 0-100%.
- Compatible with RF remote.
- Minimum brightness setting.
- Push dim function.

| Model | Input Voltage | Output Current | Output Power |
|-------|---------------|----------------|--------------------|
| S1-B | 100-240VAC | 1A× 1 channel | 110/220W(110/220V) |

Kit AC phase-cut RF Dimmer



| Model | Input Voltage | Output Current | Output Power |
|---------|---------------|----------------|--------------------|
| S1-B+R1 | 100-240VAC | 1A× 1 channel | 110/220W(110/220V) |

AC phase-cut RF dimmer



| Model | Input Voltage | Output Current | Output Power |
|-------|---------------|----------------|--------------|
| S1 | 100-240VAC | 2A× 1 channel | 200W-480W |

AC phase-cut Dimmer(RF + Push Dim)



- Dimming by buttons.
- Connect with AC push switch to achieve on/off and dimming.

| Model | Input Voltage | Output Current | Output Power |
|-------|---------------|----------------|--------------|
| TR1 | 100-240VAC | 2A× 1 channel | 200W-480W |

AC PHASE-CUT DIMMER

RF 2.4G + Push Dim

To dim single color dimmable LED, traditional incandescent and halogen lights.

Leading edge or trailing edge dimming.
Minimum brightness setting.

Model: S1-B

AC Triac Dimmer

Wall-mounted Rotary Panel Phase-cut Dimmer

- Leading edge or trailing edge dimming.
- To dim and switch dimmable LED, traditional incandescent and halogen lights.
- Microprocessor control, accurate dimming.
- Soft start.
- Memory of last lighting level.
- Compatible with RF remote.

| Input Voltage | Output Current | Output Power |
|---------------|----------------|--------------|
| 100-240VAC | Max1.2A | 120W-288W |

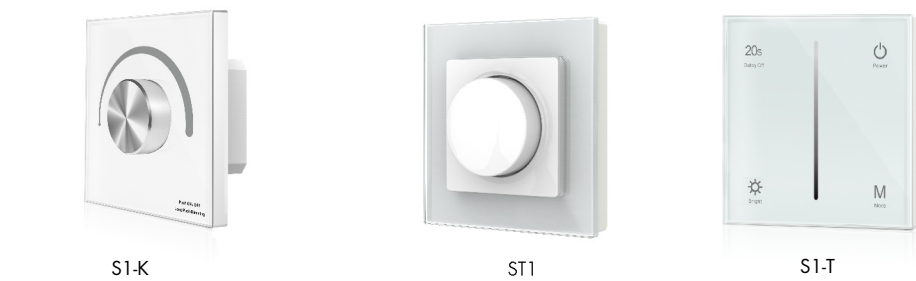

| Input Voltage | Output Current | Output Power |
|---------------|----------------|--------------|
| 100-240VAC | Max1A | 120W-240W |

AC phase-cut Dimmer(CV output)



- PWM constant voltage output
- Leading edge or trailing edge triac dimming.
- Push dim function.
- Over current, short circuit and over temperature protection.

| Model | Input Voltage | Output Current | Output Power |
|-------|---------------|----------------|---|
| V1-S | 12-48VDC | 1CH, 1.5A | 180W/ 360W/ 540W/720W (12V/24V/36V/48V) |

AC phase-cut RF Dimmer Socket



- Trailing edge dimming.
- Apply for single color dimmable LED lamps, traditional incandescent and halogen lights.
- Compatible with 2.4G remote.

| Model | Input Voltage | Output Current | Output Power |
|-------|---------------|----------------|--------------|
| SS-T | 100-240VAC | Max1.2A | 120-288W |

AC Triac Dimmer

Triac CV Dimmable LED Driver

- Dimming interface: Triac/ELV, Push Dim
- PWM digital dimming, no alter LED color rending index.
- Dimming range from 0-100%, LED start at 0.1% .
- Over-heat / Over voltage / Over load / Short circuit protection,recover automatically.
- Full protective plastic housing.
- Compliant with Safety Extra Low Voltage standard.

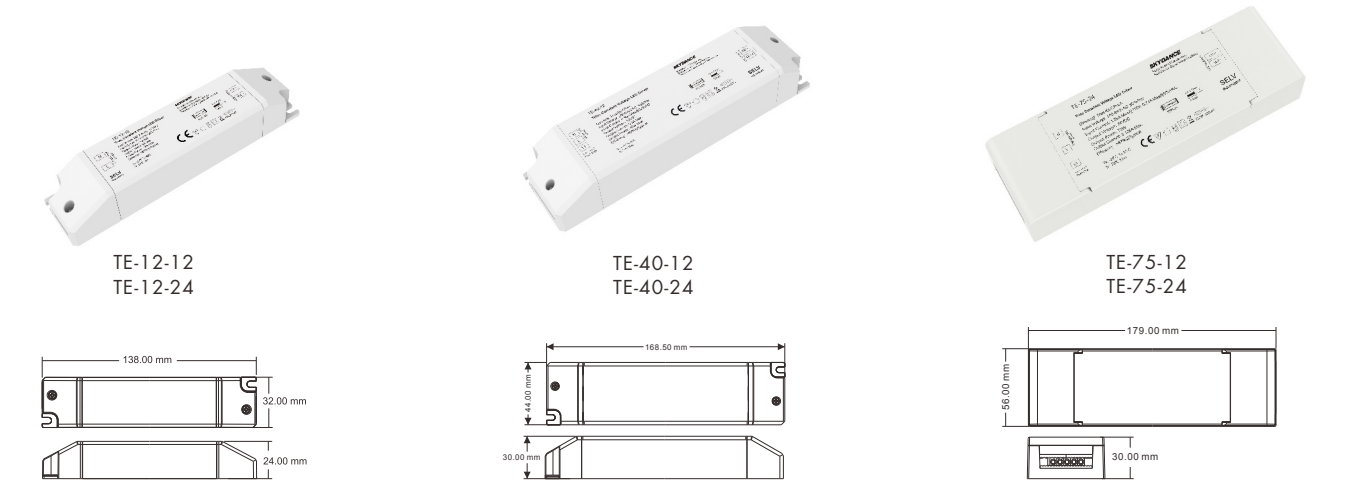

| | | | |
|---------------------|-----------------------|-------------------|--|
| Input Voltage Range | 200VAC~240VAC,50/60Hz | Withstand Voltage | I/P-O/P: 3750VAC |
| Rise Time | <0.65s | EMC Emission | En55015, EN61000-3-2 Class C, IEC61000-3-3 |
| Hold Time | 1s Max | EMC Immunity | EN61000-4-2.3.4.5.6.8.11, EN61547 |

| Model | Output W | Typical Efficiency (EFF) | No-load Power Consumption | Incrush Current | Ta,Tc |
|----------|---------------|--------------------------|---------------------------|-----------------|-----------|
| TE-12-12 | 12W/12V/1A | >82%/230VAC | <1W/230VAC | 16A/230VAC | 50°C/70°C |
| TE-12-24 | 12W/24V/1A | >82%/230VAC | <1W/230VAC | 16A/230VAC | 50°C/70°C |
| TE-40-12 | 40W/12V/3.34A | >82%/230VAC | <1W/230VAC | 27.5A/230VAC | 50°C/70°C |
| TE-40-24 | 40W/24V/1.67A | >85%/230VAC | <1W/230VAC | 27.5A/230VAC | 50°C/70°C |
| TE-75-12 | 75W/12V/6.25A | >85%/230VAC | <1W/230VAC | 27.5A/230VAC | 50°C/70°C |
| TE-75-24 | 75W/24V/3.12A | >87%/230VAC | <1W/230VAC | 27.5A/230VAC | 50°C/70°C |

Triac Dimmable LED Driver

Triac CC Dimmable LED Driver

- Dimming interface: Triac/ELV, AC Push-Dim
- Apply to leading edge/trailing edge Triac dimmers and dimming system
- PWM digital dimming, no alter LED color rending index
- 1 channel constant current output, configurable current via DIP switch
- Over-heat / Over-load / Short circuit protection, recover automatically
- Full protective plastic case
- Suitable for indoor LED lighting application
- 5 Year, 50,000hr warranty

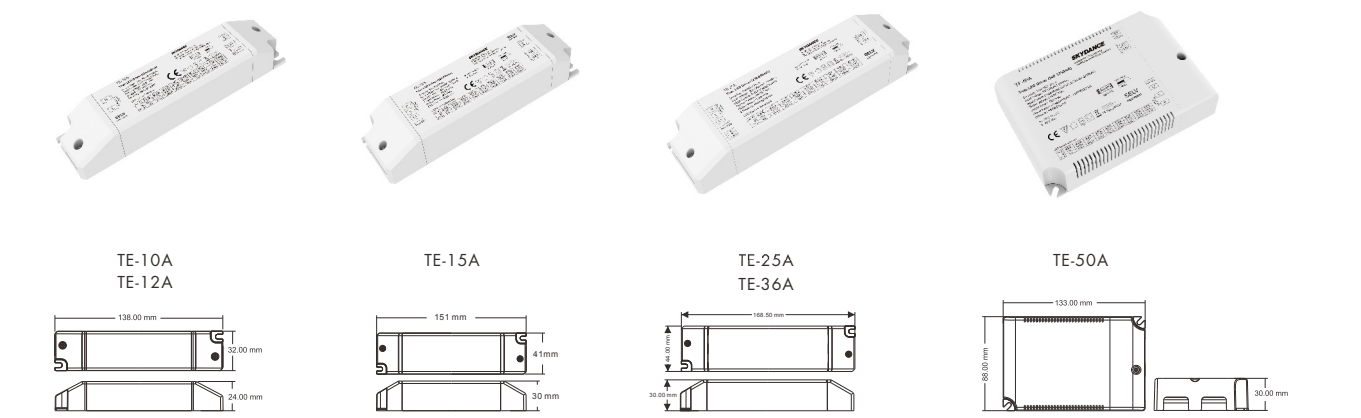

| Model | Output | Typical Efficiency (EFF) | No-load Power Consumption | Incrush Current | Ta,Tc |
|----------------------|---|--------------------------|---------------------------|-----------------|-----------|
| TE-10A 150-500mA | 10W/3-25V 150mA/200mA/250mA/ 300mA/350mA/400mA/ 450mA/500mA | >80%/220VAC | <1W | 16A/230VAC | 50°C/70°C |
| TE-12A 350mA | 12W/37V/350mA | >80%/220VAC | <1W | 16A/230VAC | 50°C/70°C |
| TE-15A 150-700mA | 15W/10-45V 150mA/200mA/350mA/ 400mA/450mA/500mA/ 650mA/700mA | >80%/220VAC | <1W | 16A/230VAC | 50°C/70°C |
| TE-25A 250-900mA | 25W/10-52V 250mA/300mA/350mA/ 400mA/500mA/600mA/ 700mA/900m | >80%/220VAC | <1.9W | 27.5A/230VAC | 50°C/70°C |
| TE-36A 350-1200mA | 36W/10-52V 350mA/500mA/600mA/ 700mA/800mA/900mA/ 1050mA/1200mA | >82%/220VAC | <1.9W | 27.5A/230VAC | 50°C/70°C |
| TE-50A | 50W/10-52V 500mA/700mA/900mA/ 1050mA/1200mA/1400mA/ 1600mA/1750mA | >82%/220VAC | <2.8W | 43.4A/230VAC | 50°C/70°C |

TRIAC LED DRIVER

Leading edge/trailing edge, PWM digital dimming

RELIABLE WITH 5 YEARS, 50,000 HOURS WARRANTY

Full protective plastic

Dimming interface: Triac/ELV, Push Dim

Dimming range from 0-100%

Configurable current via DIP switch
Over-heat / Over-load / Short circuit
protection, recover automatically



TE-12-12



TE-15A



TE-40-24



TE-75-12



TE-50A