

Model	Product name	Product picture	Size	Sensor data
EB(C)	Infrared wireless hand sweep sensing head			Sensitive field: $\leq 10\text{cm}$ Sensitive angle: 15-30
ED(C)	Infrared wireless door sensing head			Sensitive field: $\leq 8\text{cm}$ Sensitive angle: 15-30

Features

- Powered by low voltage 5VDC, output 5V level or PWM signal.
- Can be used with constant voltage LED dimming power supply.
- Apply to cabinet, closet, wine cabinet and other lighting.
- Output PWM frequency: 2000Hz.

Sensor Wire Define

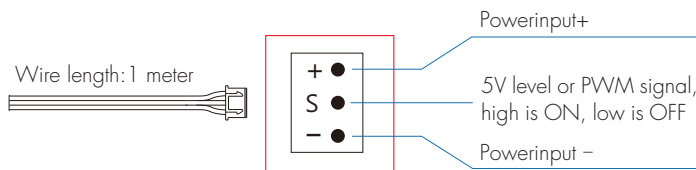

Sensing Head Installation

- Concealed installation:

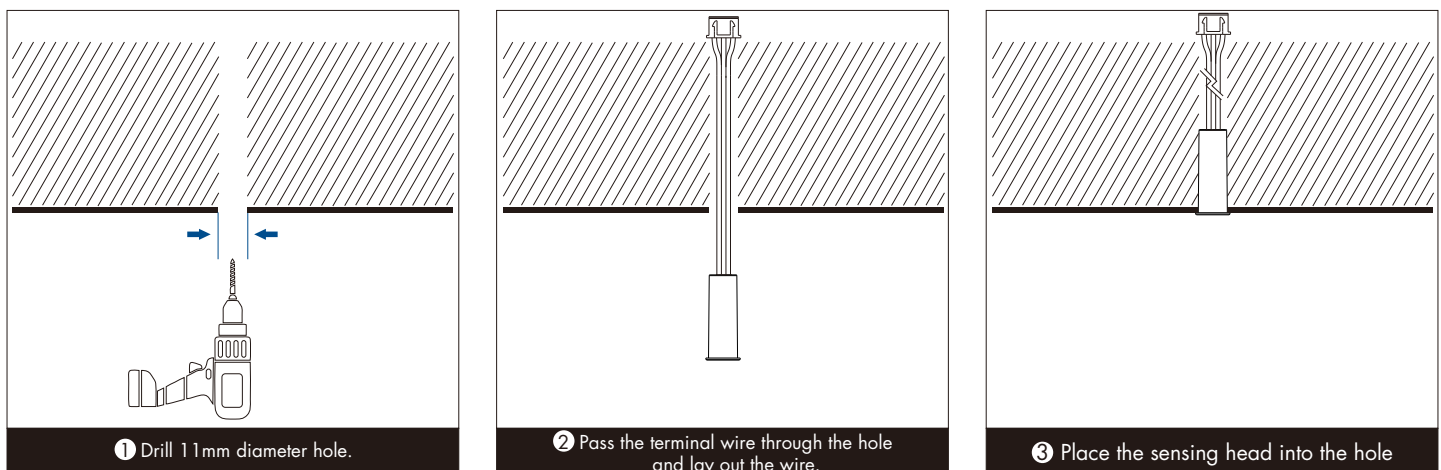

● Surface mounting method:

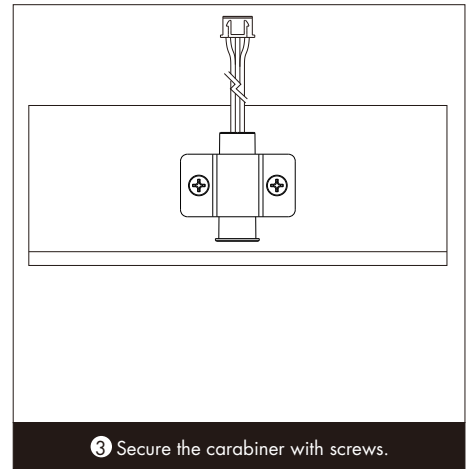
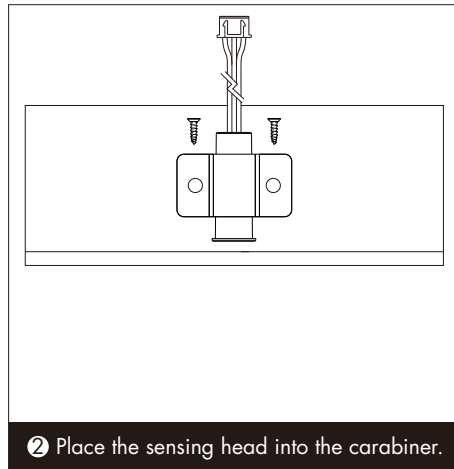
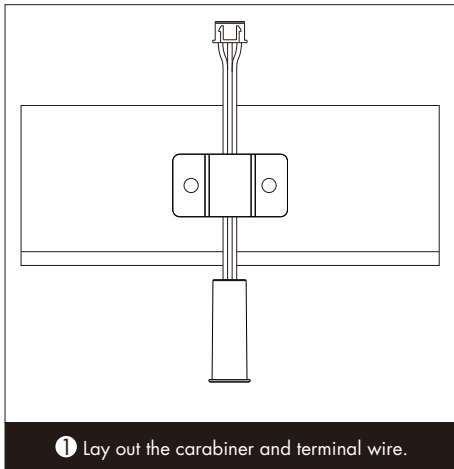

### Sensing Head Application

**EB(C): Infrared wireless hand sweep sensing head**

Make pendulum action at the front end of the sensing head:  
 when hand sweep, the light turn on gradually;  
 when hand sweep again, the light turn off gradually.

Hold your hand in front of the sensing head for more than 2 seconds:  
 The brightness increases or decreases continuously,  
 the each time the hand is removed and then held again,  
 the brightness changes in the opposite direction.

**ED(C): Infrared wireless door sensing head**

Use the door as a reflection object.  
 It is installed at the outer edge of the cabinet door, about 1 cm away from  
 the outer edge.

When the door open, or no obstacle in front of the sensing head,  
 the light turn on gradually;  
 When the door close, or obstacle in front of the sensing head,  
 the light turn off gradually.

### Packing List



Induction sensor head  
1 pcs

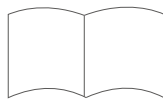

User manual  
1 pcs



Carabiner  
1 pcs



Screw  
2 pcs